

CHE

HEAT TRANSFER PRODUCTS

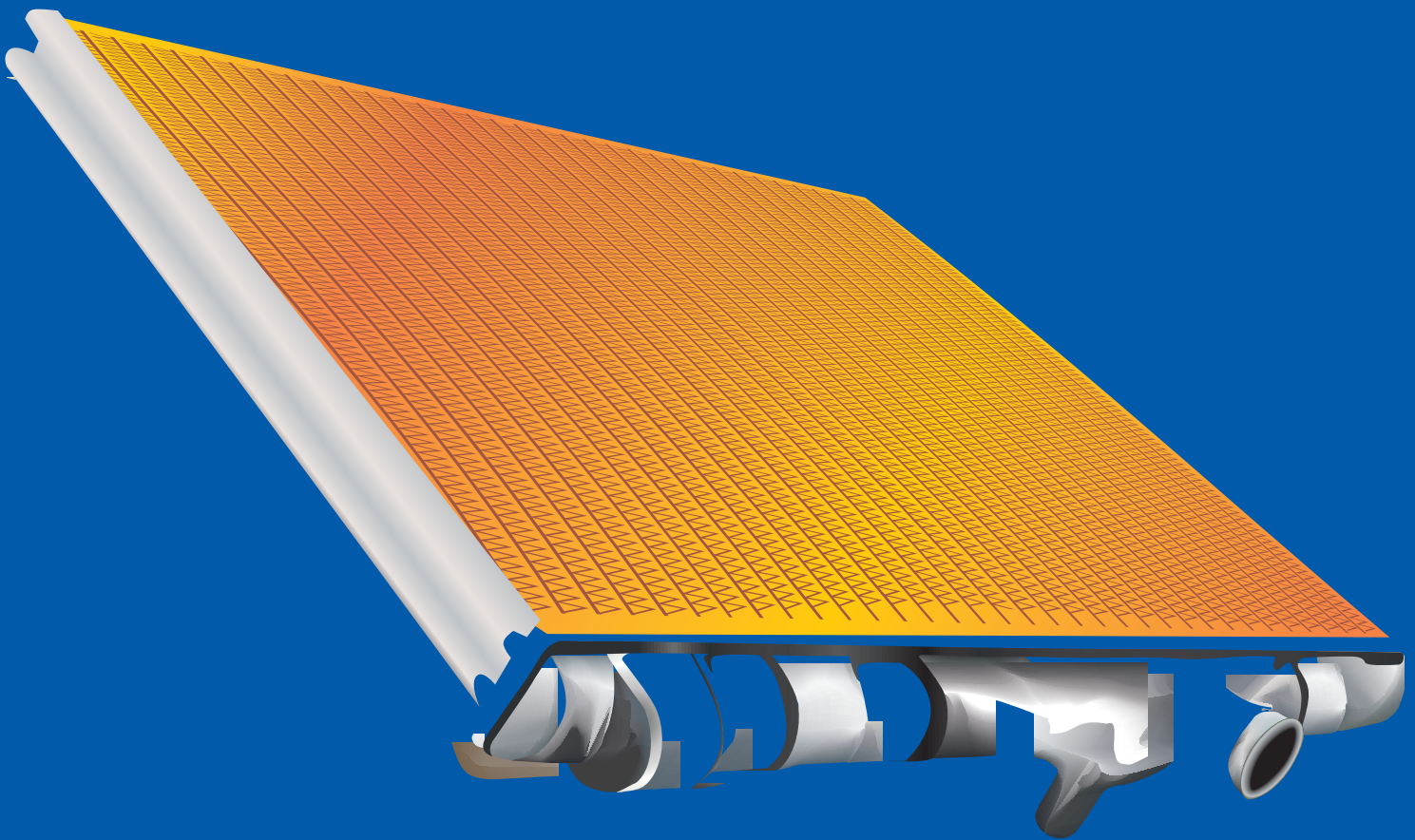

RADIATORS

www.CHE.co.za

CONTENTS

RADIATORS

AUSTIN
BELL
CATERPILLAR
FREIGHTLINER
HITACHI
INTERNATIONAL
ISUZU
KOMATSU
MAHINDRA
MAN
MORGAN
NISSAN
SWIMMING POOL
TOYOTA
VOLVO

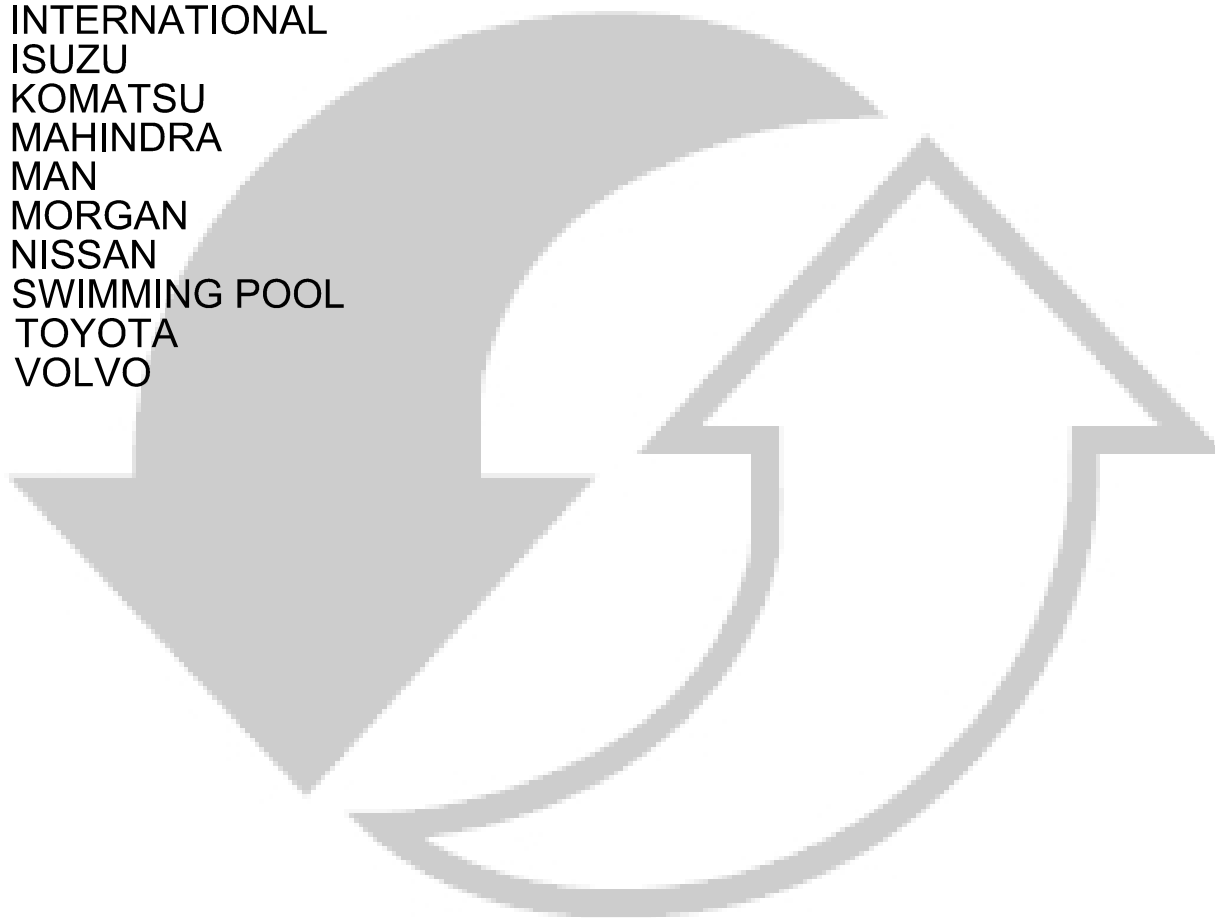

RADIATOR-AUSTIN

Cape Heat Exchange is proud to announce the newly developed aluminium **Austin Healey 100-6 and 3000 radiator**. The radiator was developed as a replacement radiator to the classic Austin Healey 100-6 (1959-1959) and 3000 (1959-1967) model. The original radiator is a copper unit and to improve on its cooling performance, overall weight and price an all-aluminium radiator was developed by using technology that is currently available. It is a tube and bar system, with the tubes being thick walled extrusions and there are no header plates. This radiator will take care of any overheating problems and ensure the user can enjoy driving this beautiful vintage car.

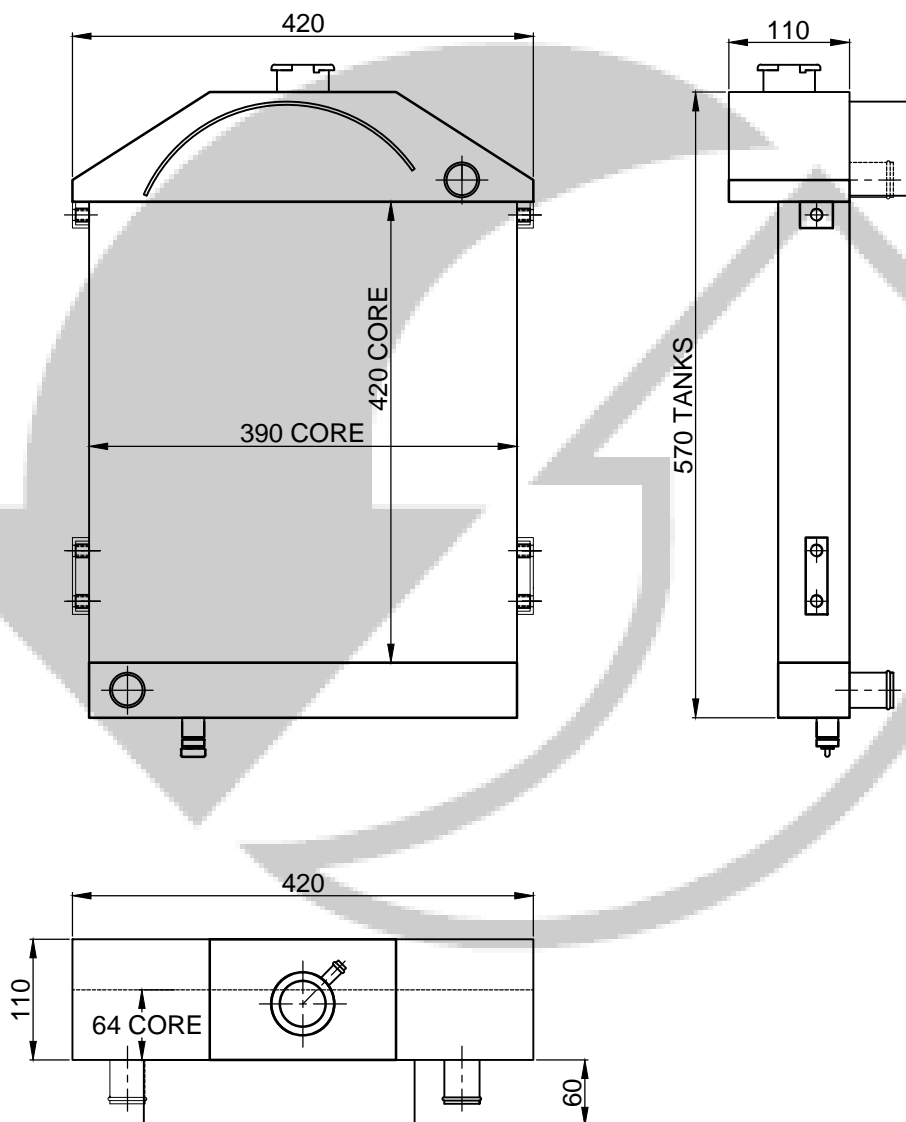

MODEL:AUSTIN HEALEY 100/6 AND 3000

PART NUMBER:RAD420AUS1COM

RADIATOR-BELL

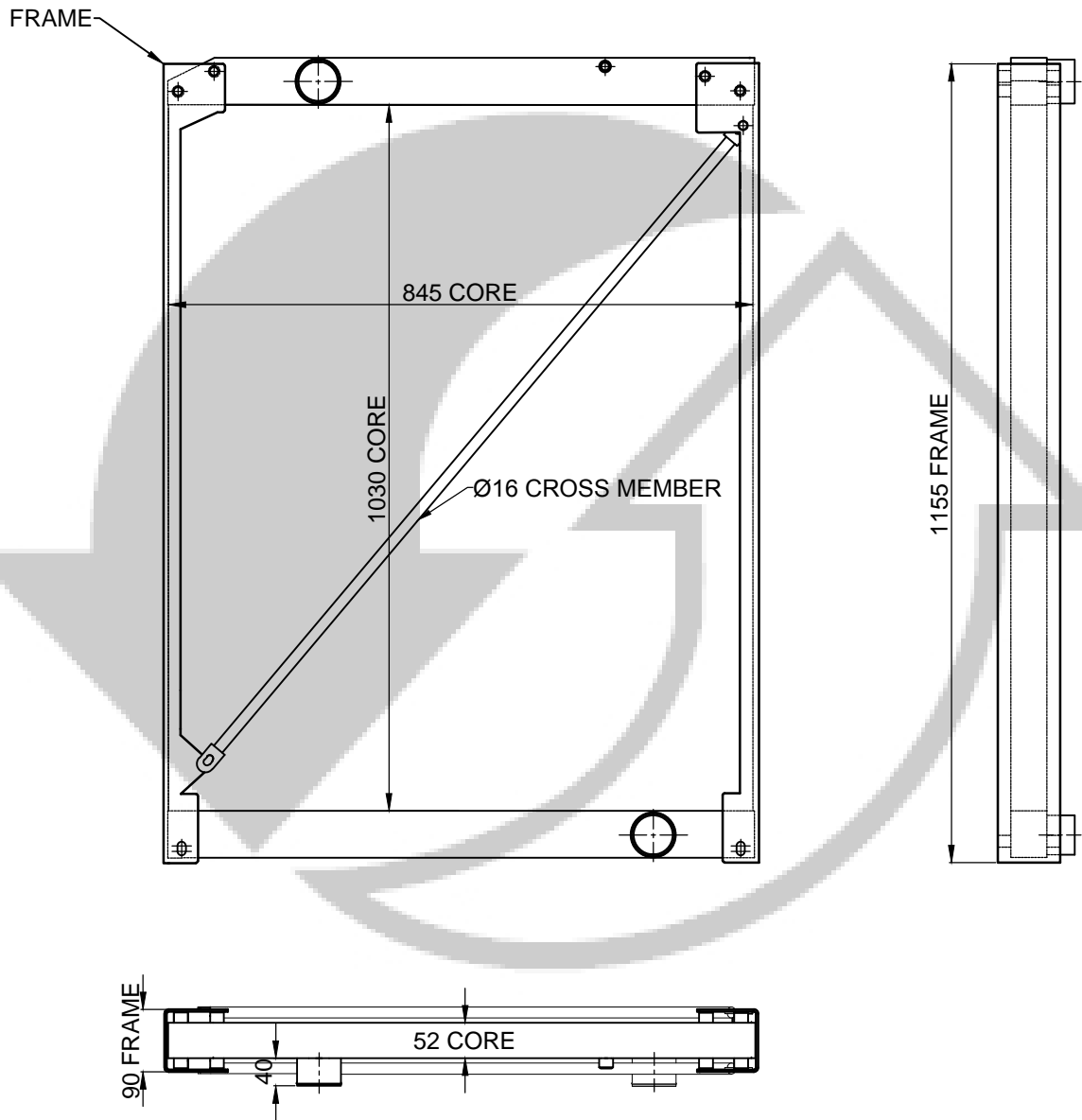

MODEL: BELL DUMPER

PART NUMBER: RAD1030BEL1COM

RADIATOR-CATERPILLAR

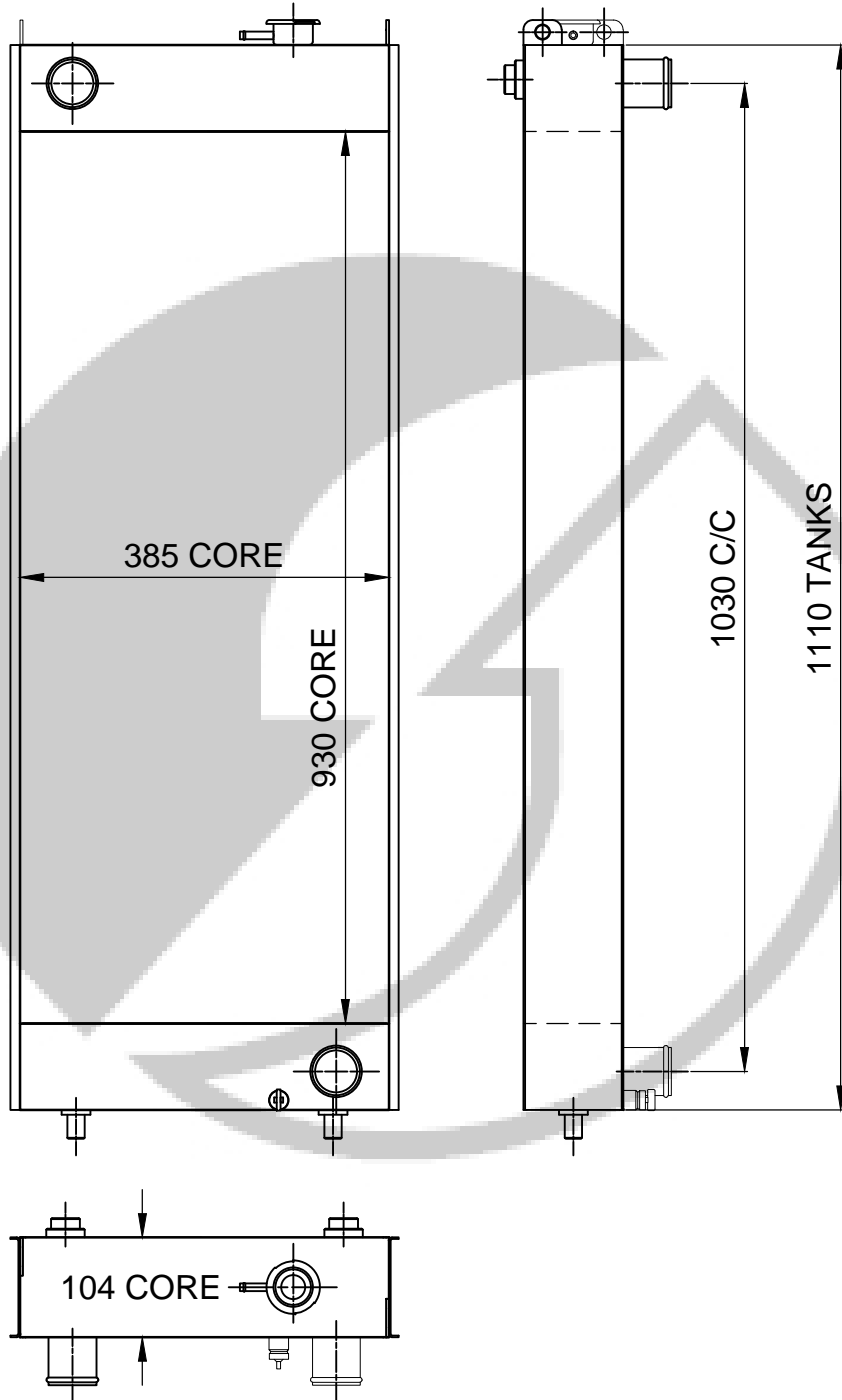

MODEL:CATERPILLAR 320L

PART NUMBER:RAD930CAT1COM

RADIATOR-FREIGHTLINER

Cape Heat Exchange is proud to announce the newly developed aluminium *Freightliner Argosy radiator*. The radiator was developed with South African temperatures and road conditions in mind. It is a tube and bar system. The tubes are thick walled extrusions and there are **no header plates**, this reduces the interfaces that might cause leakages and we are confident that this is the **strongest Freightliner radiator** on the market. Different to the OEM and aftermarket radiator, this radiator is entirely made of aluminium with no plastic tanks. The aluminium tanks are similar in weight to the plastic tanks and because they are welded to the core it increases the strength and durability of the complete radiator.

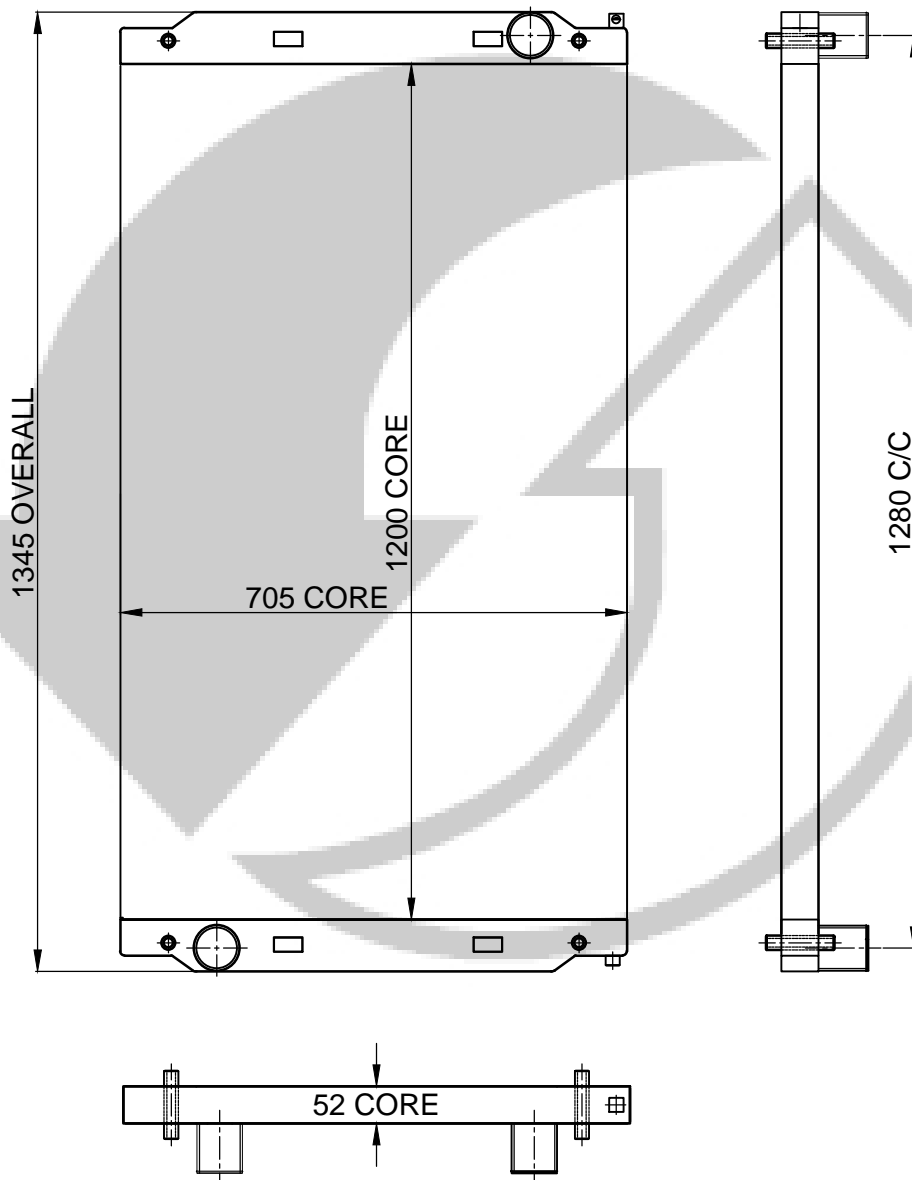

MODEL:FREIGHTLINER ARGOSY

PART NUMBER:RAD1200FR1COM

RADIATOR-HITACHI

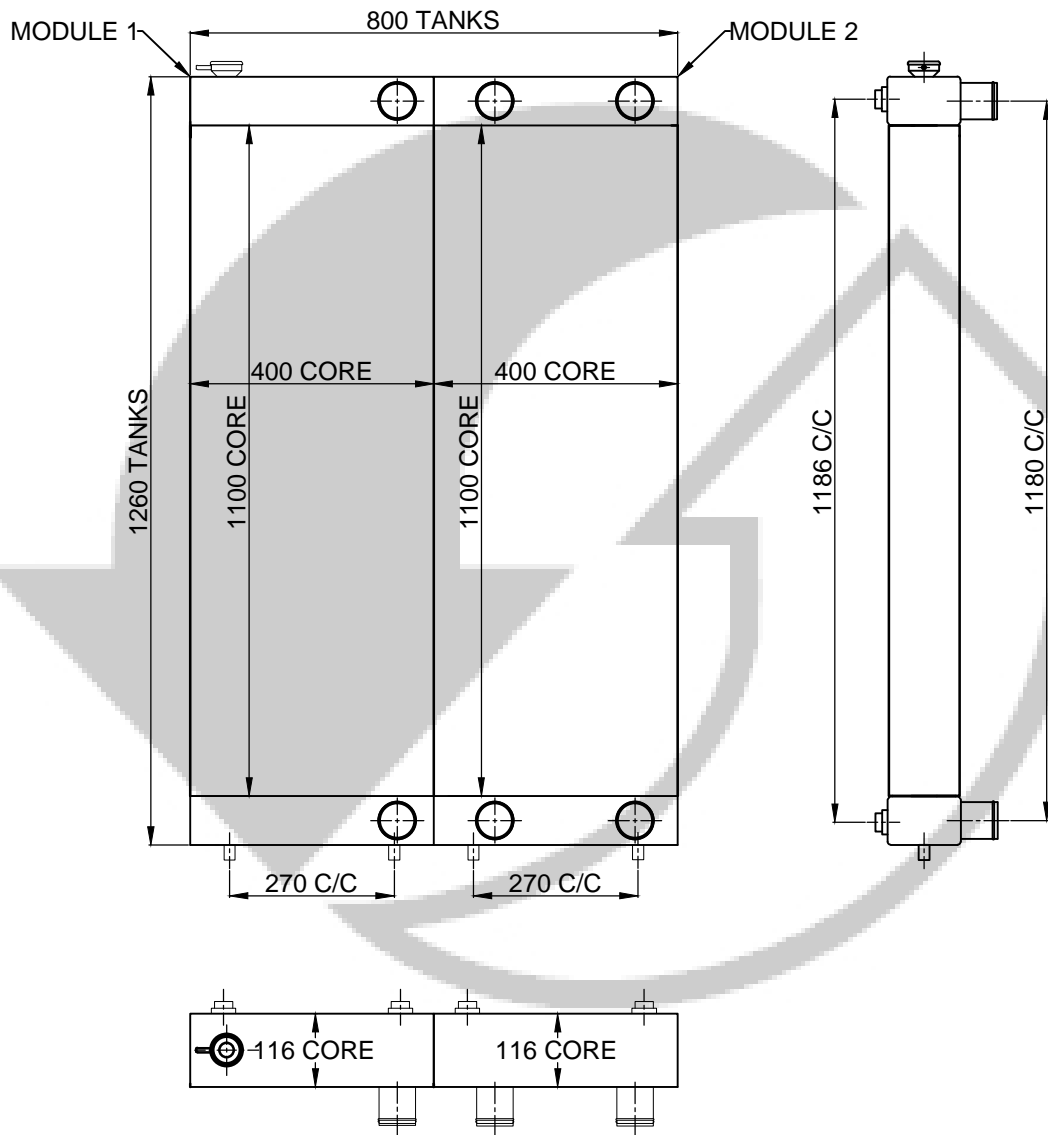

MODEL:HITACHI ZX680

PART NUMBER:RAD1100HIT1COM

RADIATOR-HITACHI

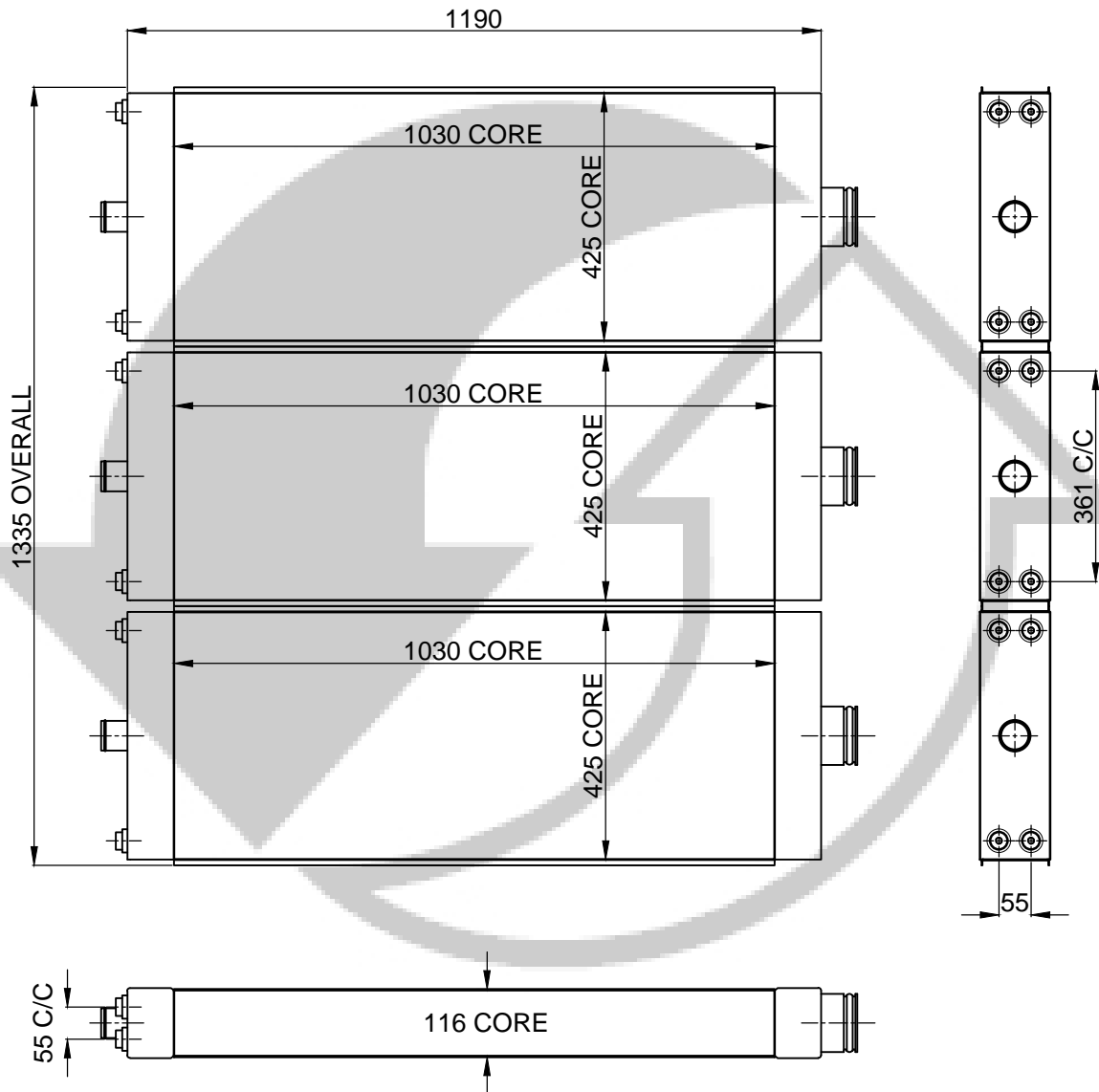

MODEL:HITACHI ZX870

PART NUMBER:RAD1030HIT1COM

RADIATOR-INTERNATIONAL

Cape Heat Exchange is proud to announce the newly developed aluminium *International Eagle radiator*. The radiator was developed with South African temperatures and road conditions in mind. As this unit is utilized in trucks that mostly travel long distances durability is of utmost importance. It is a tube and bar system. The tubes are thick walled extrusions and there are **no header plates**, this reduces the interfaces that might cause leakages and we are confident that this is the **strongest International Eagle radiator** on the market. Different to the OEM and aftermarket radiator, this radiator is entirely made of aluminium with no plastic tanks. The aluminium tanks are similar in weight to the plastic tanks and because they are welded to the core it increases the strength and durability of the complete radiator.

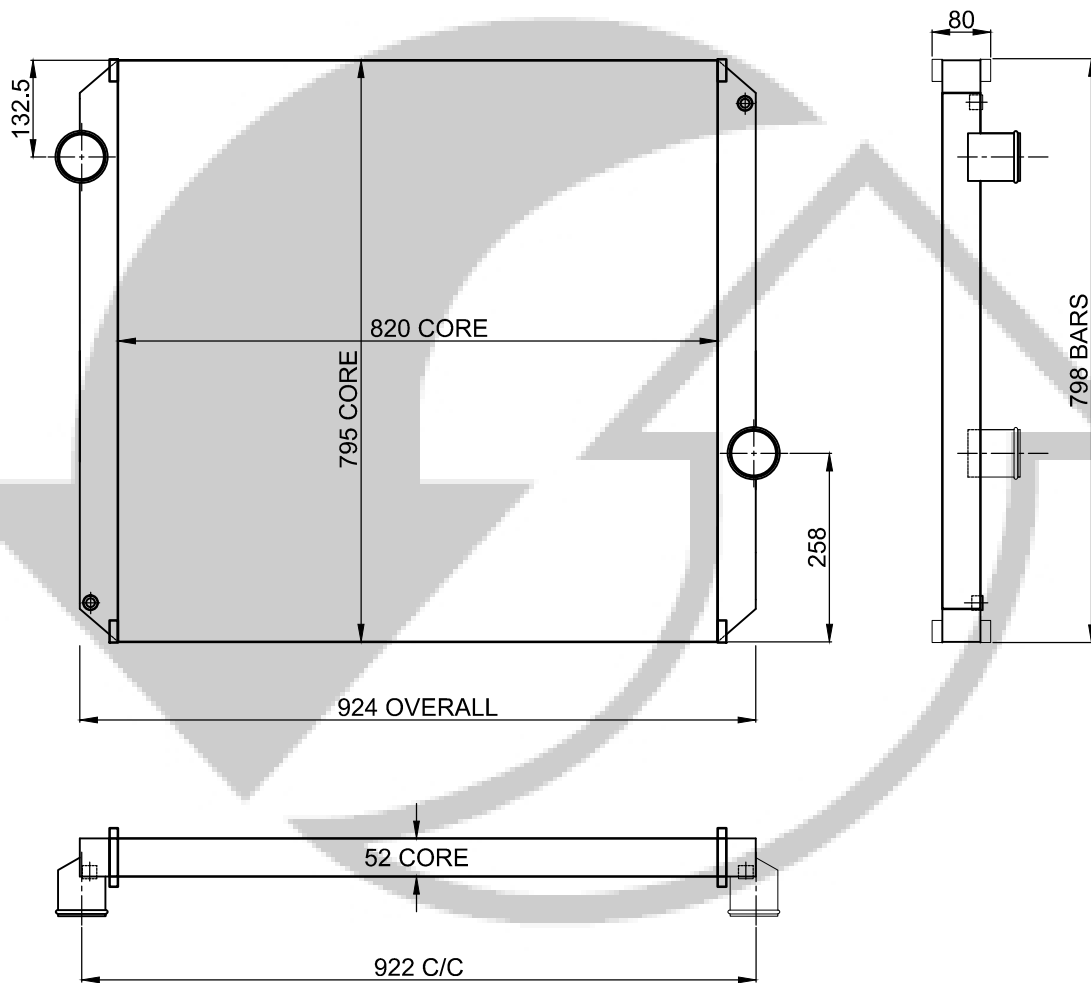

MODEL:INTERNATIONAL EAGLE 9800i

PART NUMBER:RAD820INT1COM

RADIATOR-ISUZU

Is your Isuzu FXZ truck working in harsh conditions? Or do you just want to add more durability to your fleet?

Cape Heat Exchange is proud to announce the newly developed **Isuzu FXZ truck Radiator** (RAD880ISU1COM). The unit was developed with harsh operating conditions and durability in mind.

The tanks are made from aluminium, thus it is stronger than the standard plastic tanks but similar in weight. This radiator doesn't consist of any header plates, the aluminium tanks are directly welded to the core which increases the strength and durability of the complete radiator. The core consist of a tube and bar system and the tubes are thick walled extrusions.

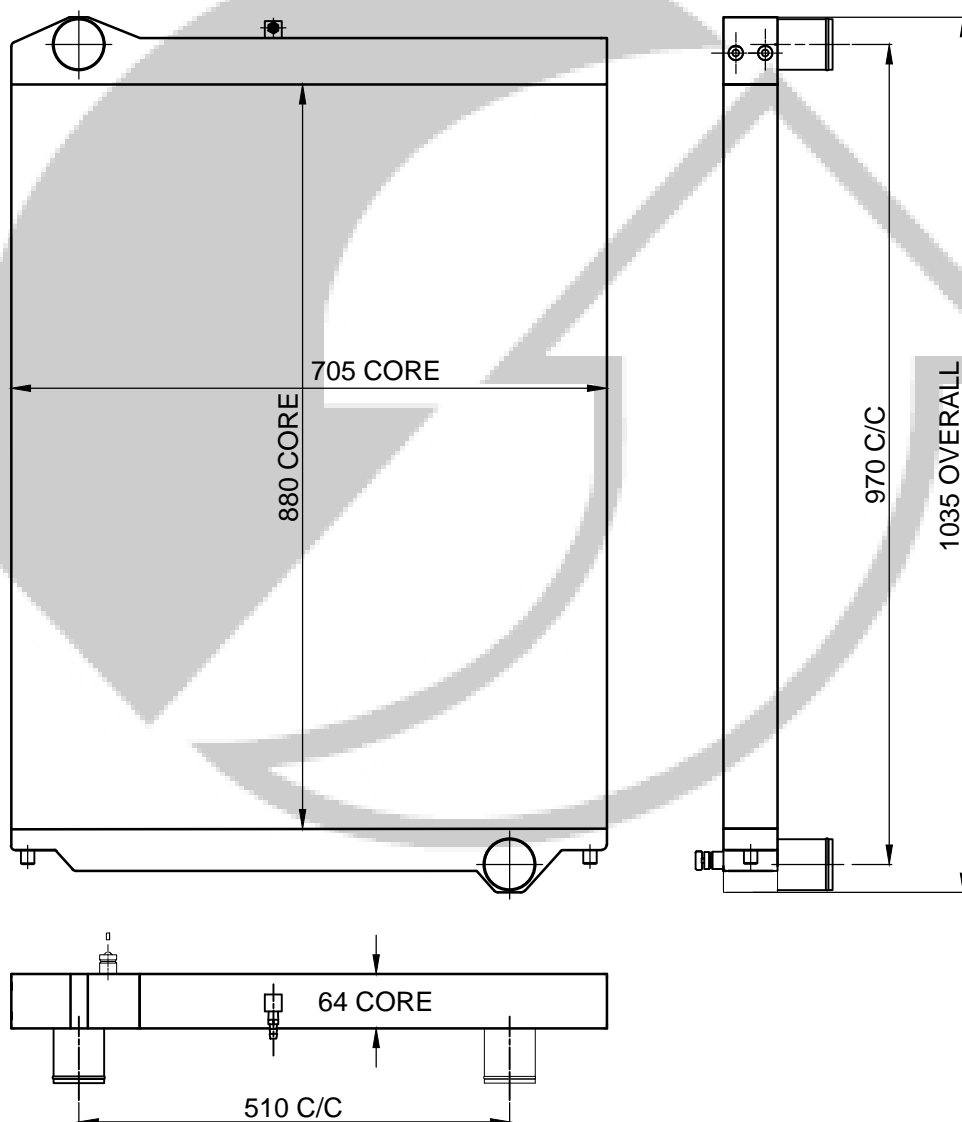

MODEL:ISUZU FXZ

PART NUMBER:RAD880ISU1COM

RADIATOR-KOMATSU

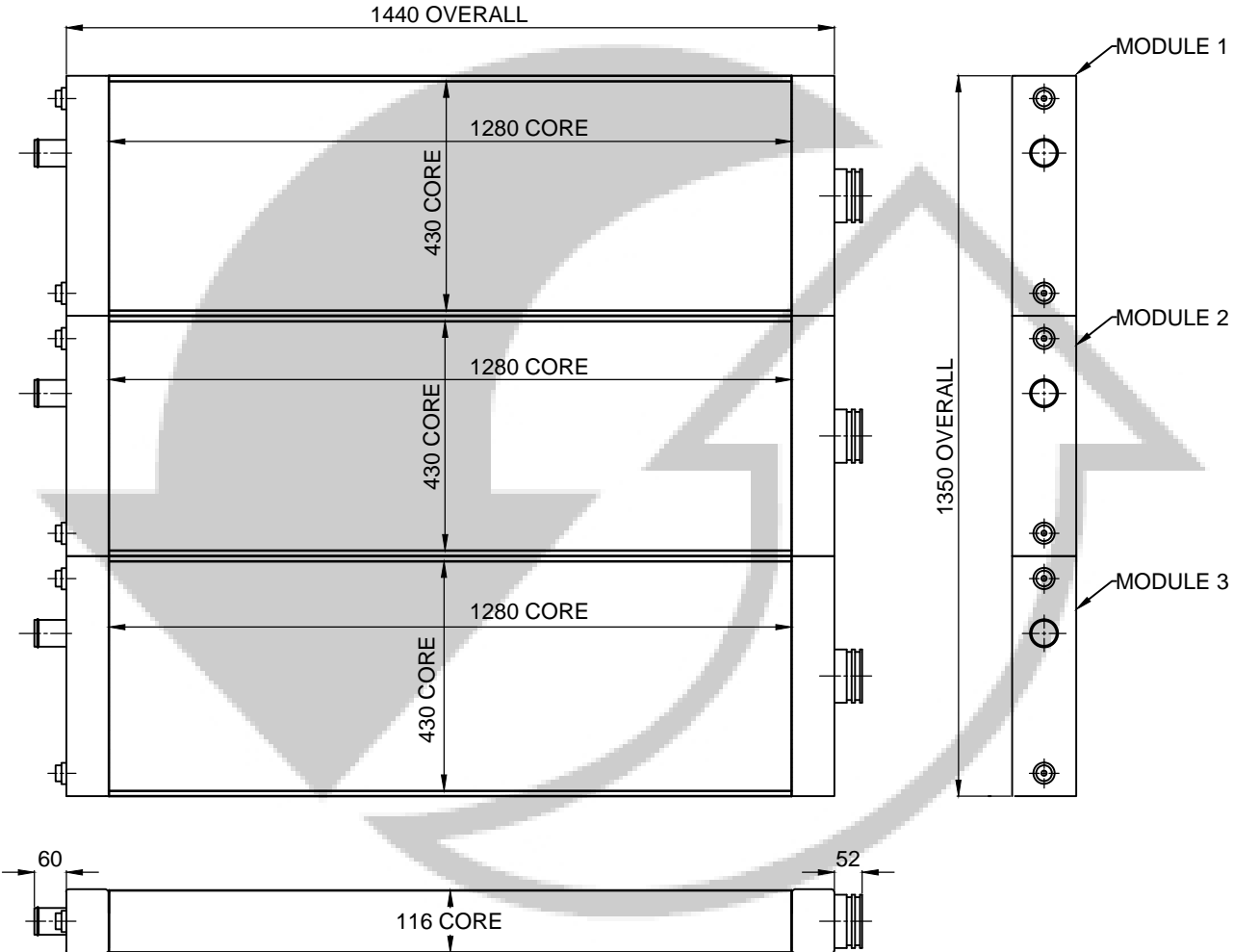

MODEL:KOMATSU D375

PART NUMBER:RAD1280KOM1COM

RADIATOR-KOMATSU

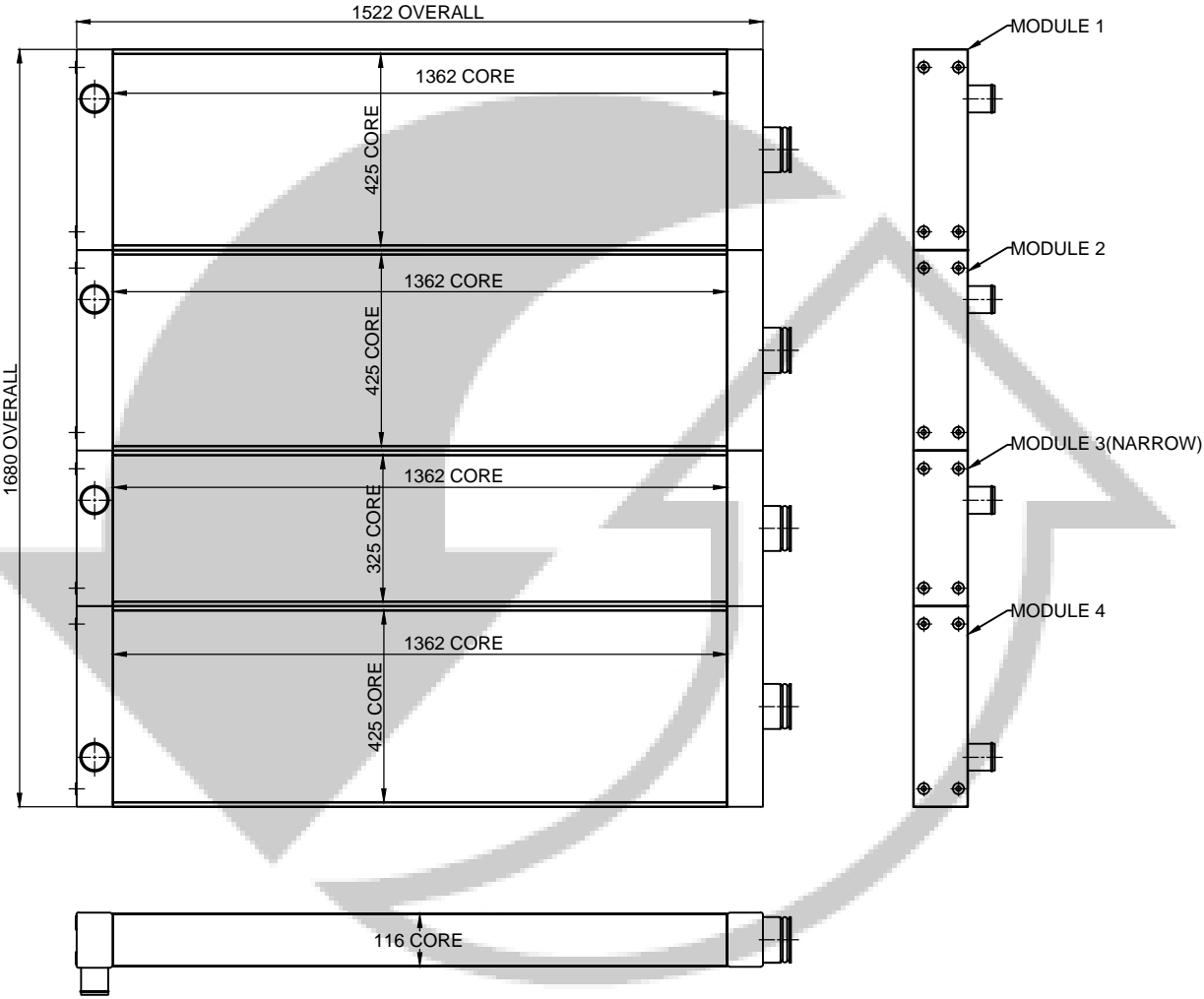

MODEL:KOMATSU D785

PART NUMBER:RAD1362KOM1COM

RADIATOR- MAHINDRA

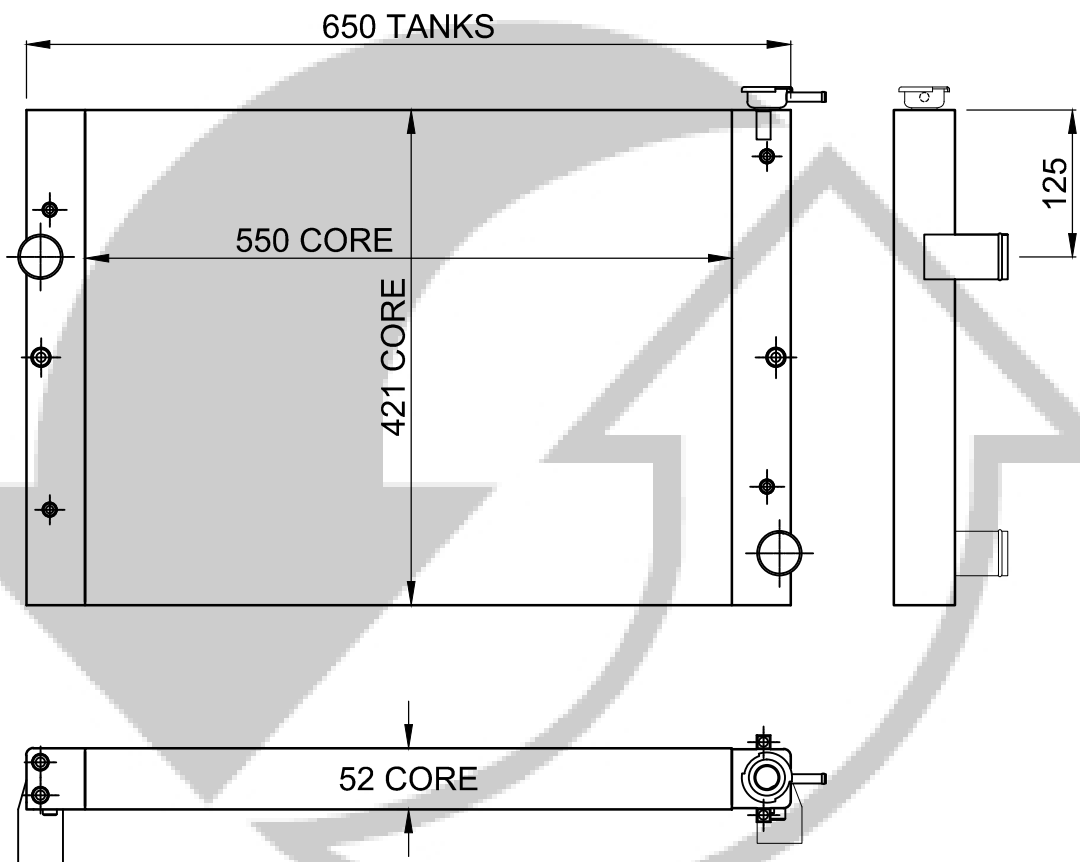

MODEL:MAHINDRA

PART NUMBER:RAD550MAH1COM

RADIATOR- MAHINDRA

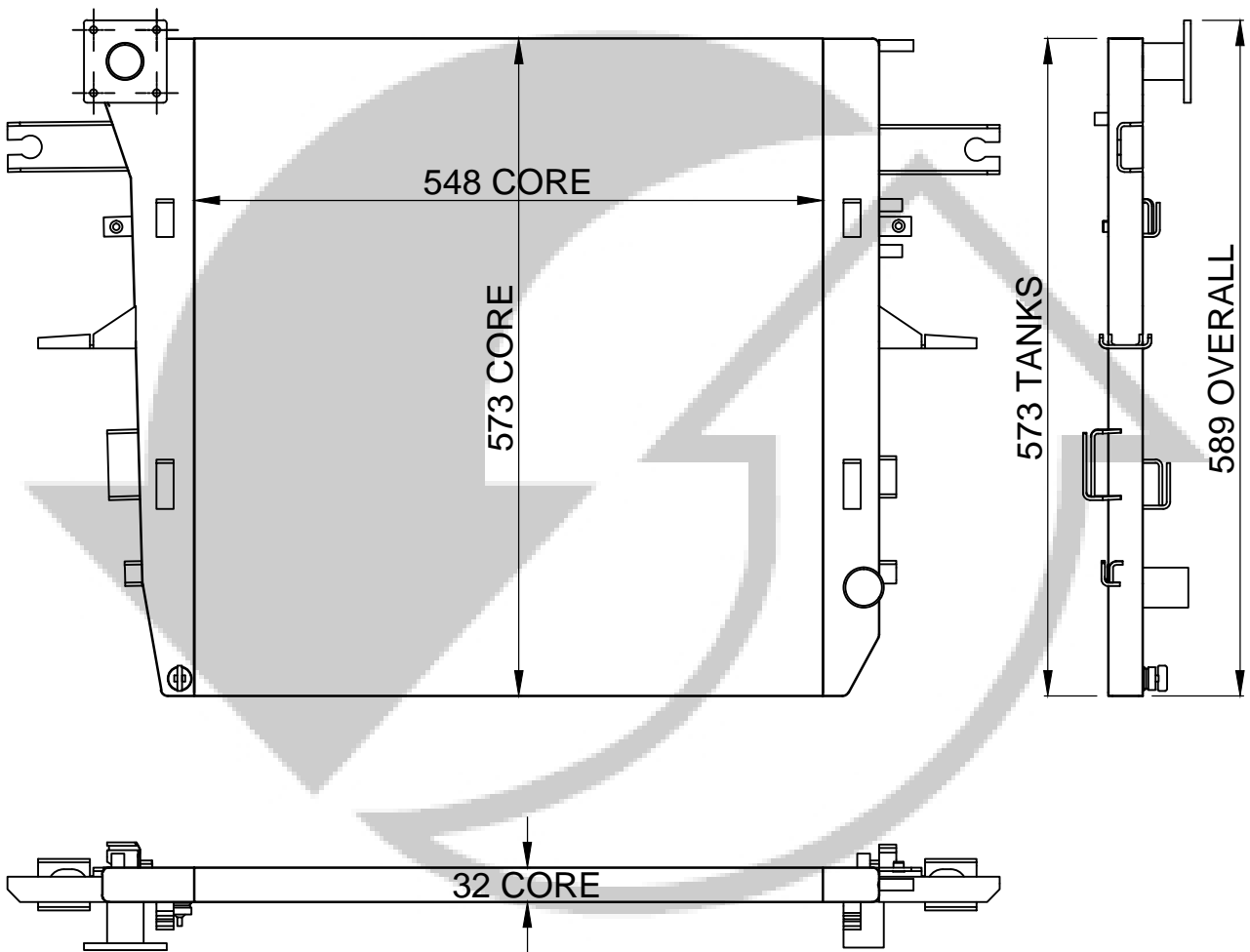

MODEL:MAHINDRA

PART NUMBER:RAD548MAH1COM

RADIATOR-MAN

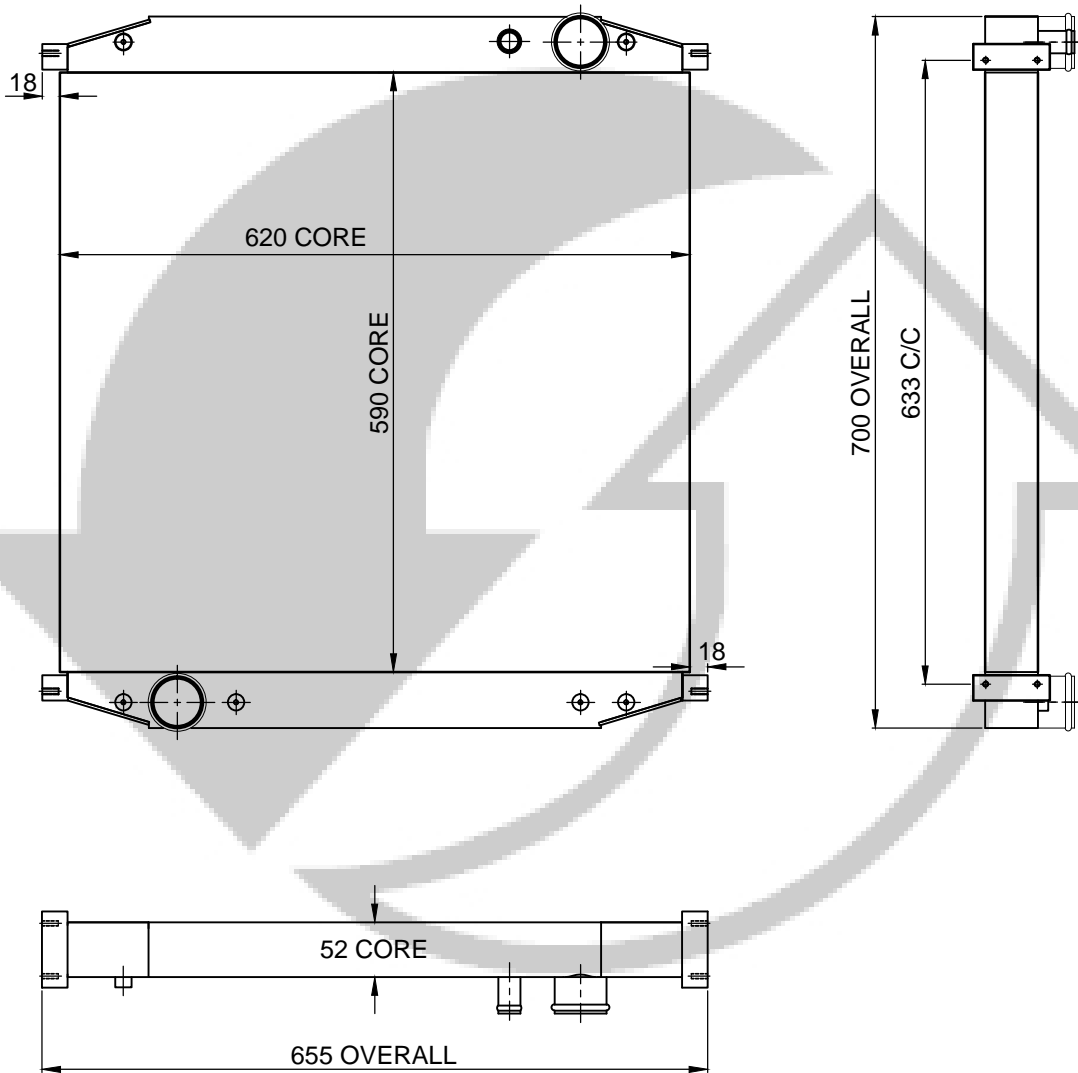

MODEL:590 MAN CLA RANGE V1

PART NUMBER:RAD590MAN1COM

RADIATOR-MAN

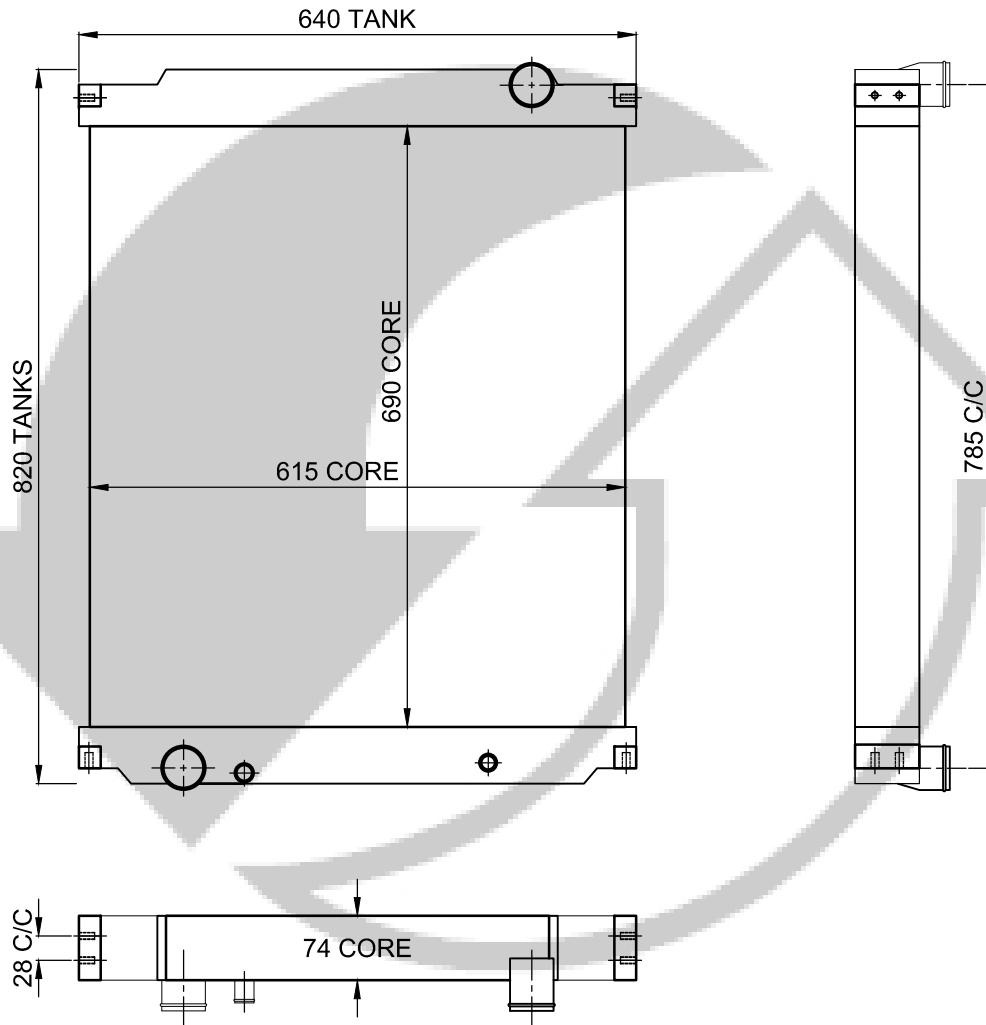

MODEL:690 MAN CLA V2

PART NUMBER:RAD690MAN1COM

RADIATOR-MAN

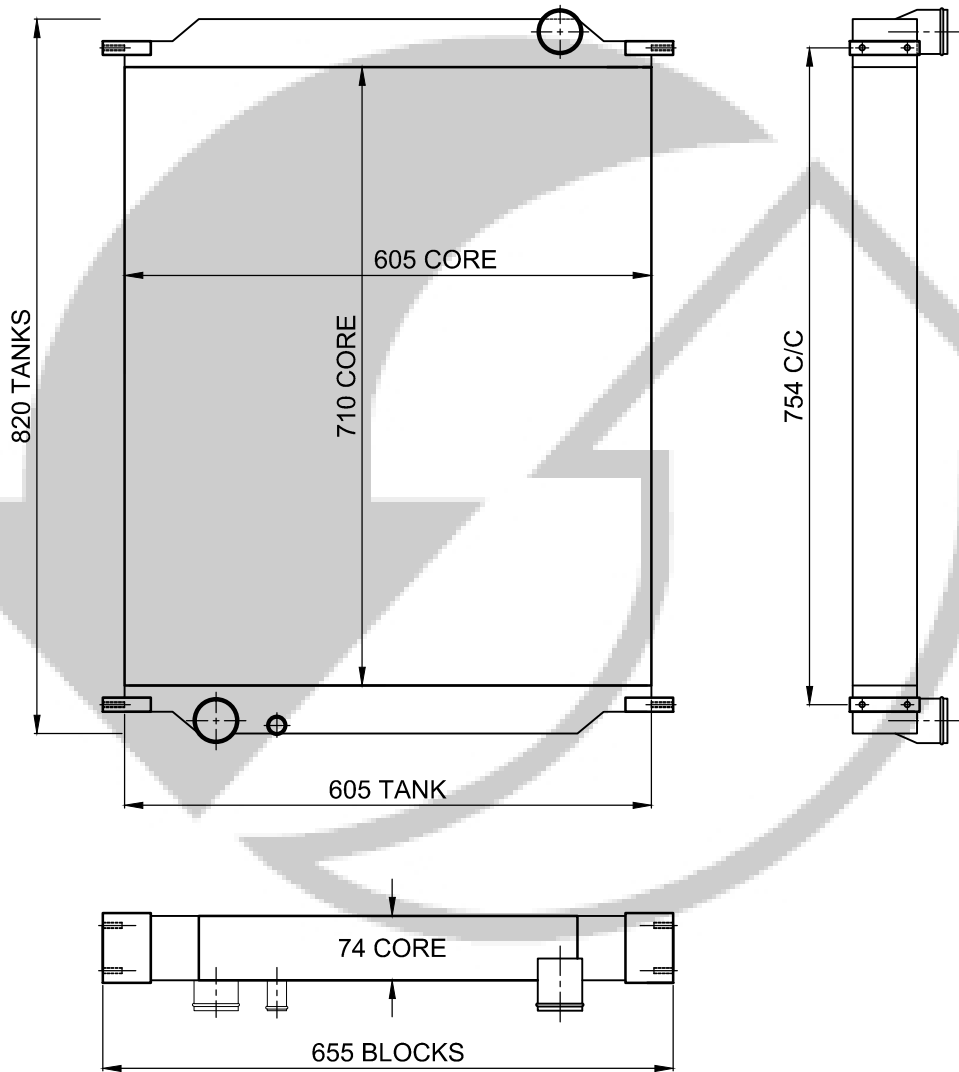

MODEL:710 MAN LE280 TGM RANGE

PART NUMBER:RAD710MAN1COM

RADIATOR-MORGAN

Cape Heat Exchange is proud to announce the newly developed aluminium **Morgan Plus 8 radiator**. The radiator was developed as a replacement radiator to the classic Morgan Plus 8 (1968-present) model. The original radiator is a copper unit and this specific model Morgan was renowned for overheating problems and as a result this improved radiator was developed by using technology that is currently available. The complicated tanks were replicated and as such the user won't need to worry about modifications that needs to be made. It is a tube and bar system, with the tubes being thick walled extrusions and there are no header plates. The radiator is entirely made of aluminium, it is cheaper and lighter than an original replacement and much more efficient. This radiator will enable the user to drive the car and simply enjoy the beauty of the past and technology of the future without worrying about overheating problems.

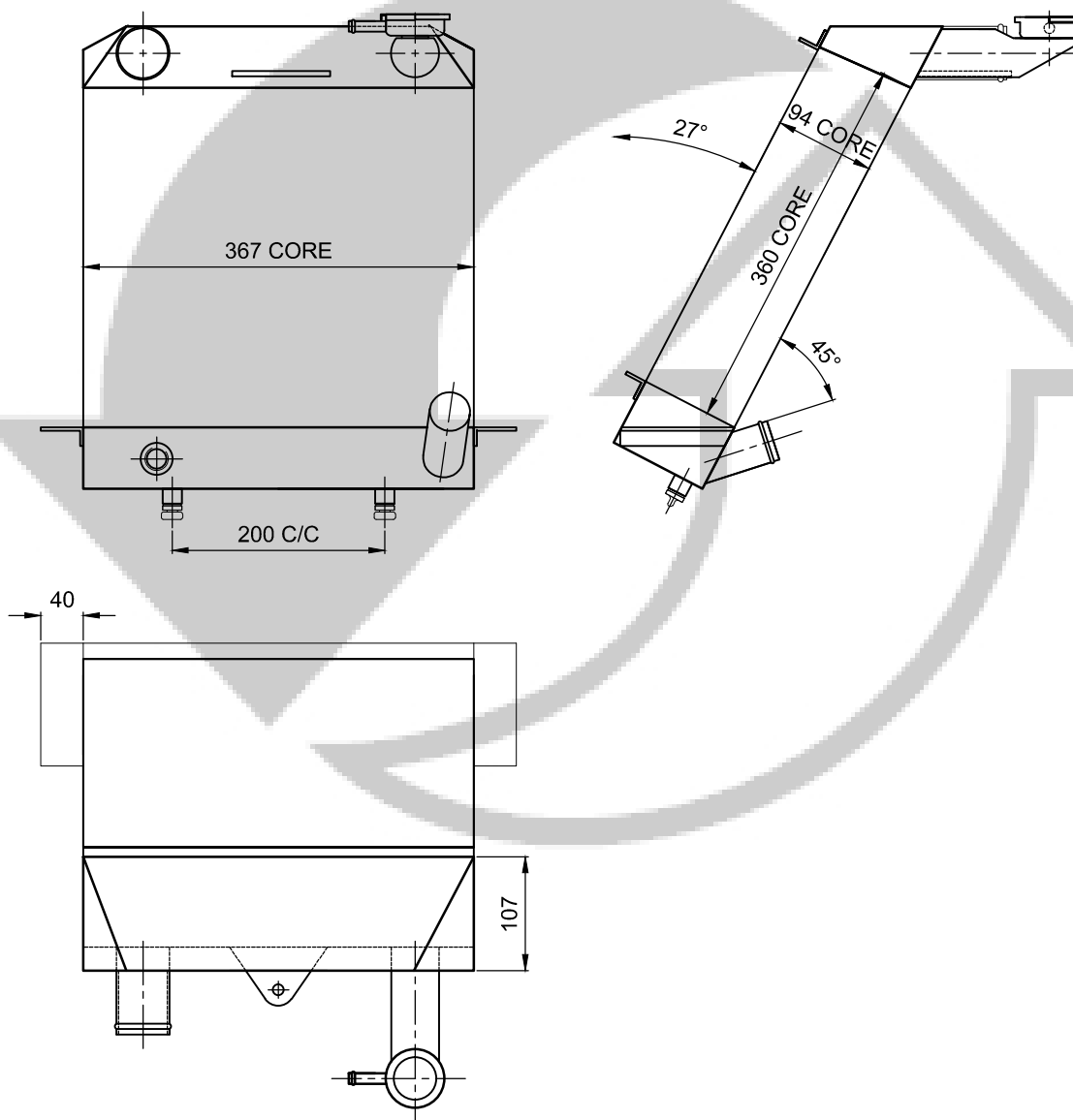

MODEL:MORGAN PLUS 8

PART NUMBER:RAD360MOR1COM

RADIATOR-NISSAN

Cape Heat Exchange is proud to announce the newly developed aluminium **Nissan UD 440**. The radiator was developed with South African temperatures and road conditions in mind. As this unit is utilized in trucks that mostly travel long distances durability is of utmost importance. It is a tube and bar system. The tubes are thick walled extrusions and there are **no header plates**, this reduces the interfaces that might cause leakages and we are confident that this is the **strongest Nissan UD 440 radiator** on the market. Different to the OEM and aftermarket radiator, this radiator is entirely made of aluminium with no plastic tanks. The aluminium tanks are similar in weight to the plastic tanks and because they are welded to the core it increases the strength and durability of the complete radiator.

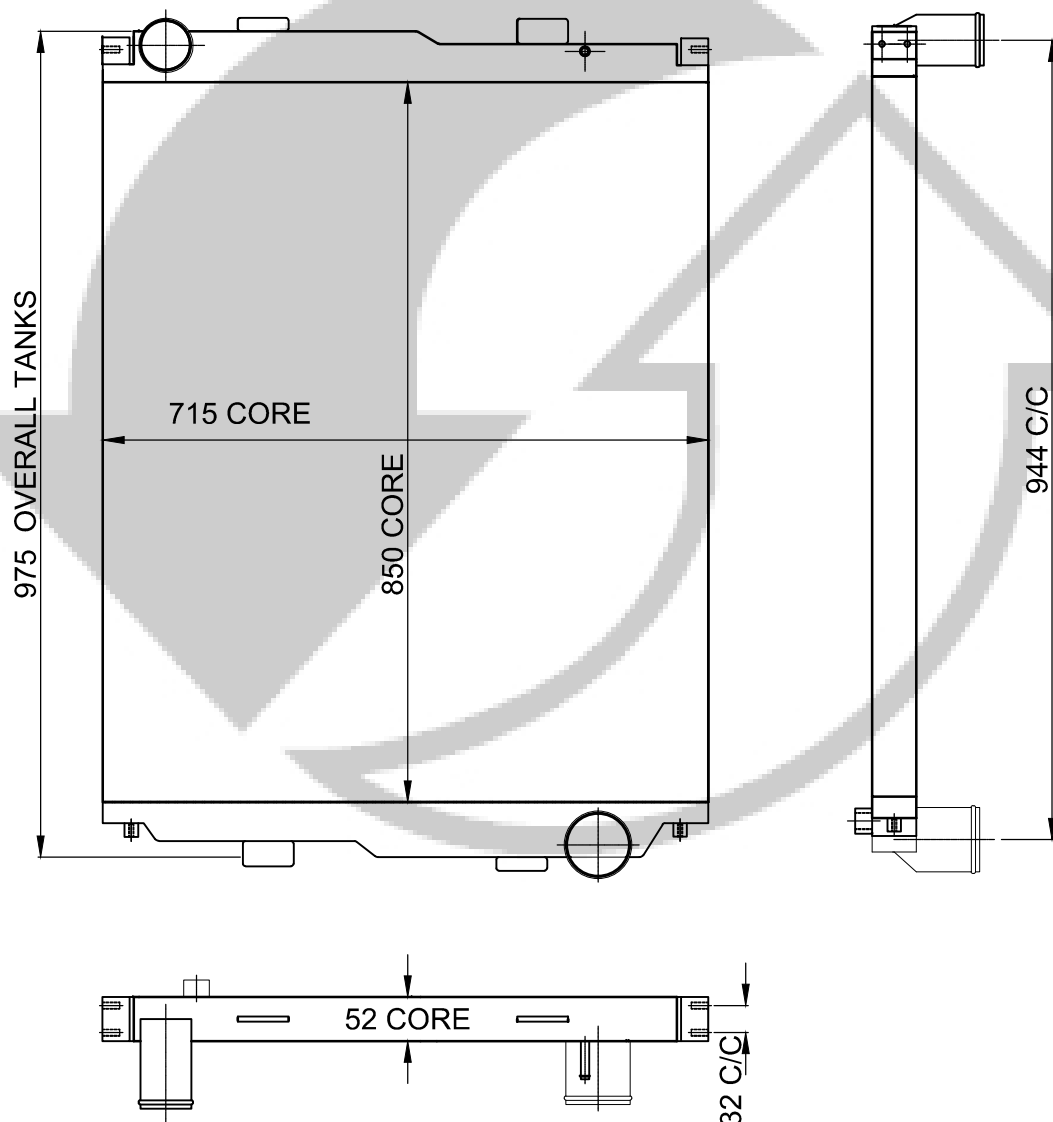

MODEL:NISSAN UD440

PART NUMBER:RAD850NIS1COM

RADIATOR-NISSAN

Cape Heat Exchange is proud to announce the newly developed aluminium **Nissan UD 370**. The radiator was developed with South African temperatures and road conditions in mind. As this unit is utilized in trucks that mostly travel long distances durability is of utmost importance. It is a tube and bar system. The tubes are thick walled extrusions and there are **no header plates**, this reduces the interfaces that might cause leakages and we are confident that this is the **strongest Nissan UD 370 radiator** on the market. Different to the OEM and aftermarket radiator, this radiator is entirely made of aluminium with no plastic tanks. The aluminium tanks are similar in weight to the plastic tanks and because they are welded to the core it increases the strength and durability of the complete radiator.

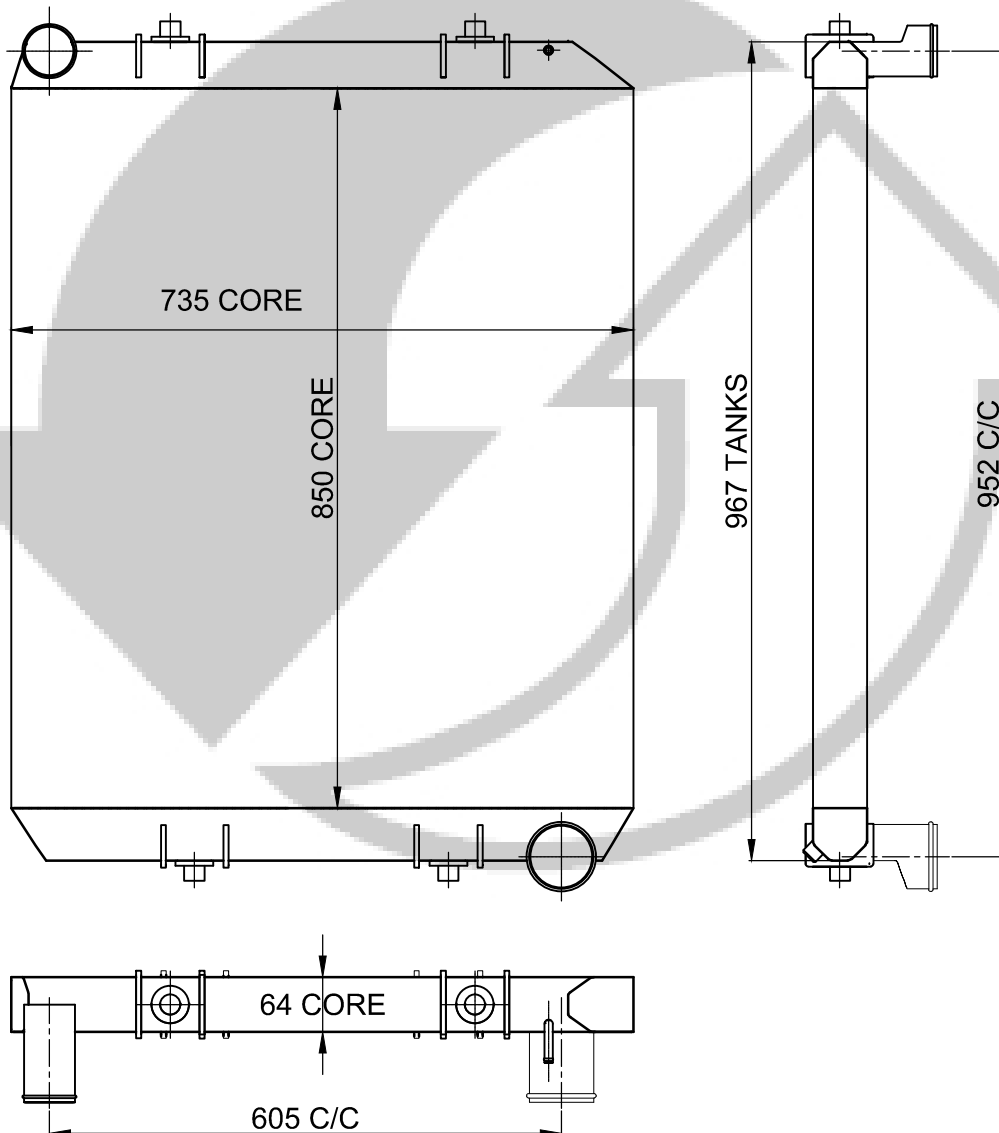

MODEL:NISSAN UD 370

PART NUMBER:RAD850NIS2COM

RADIATOR-SWIMMING POOL

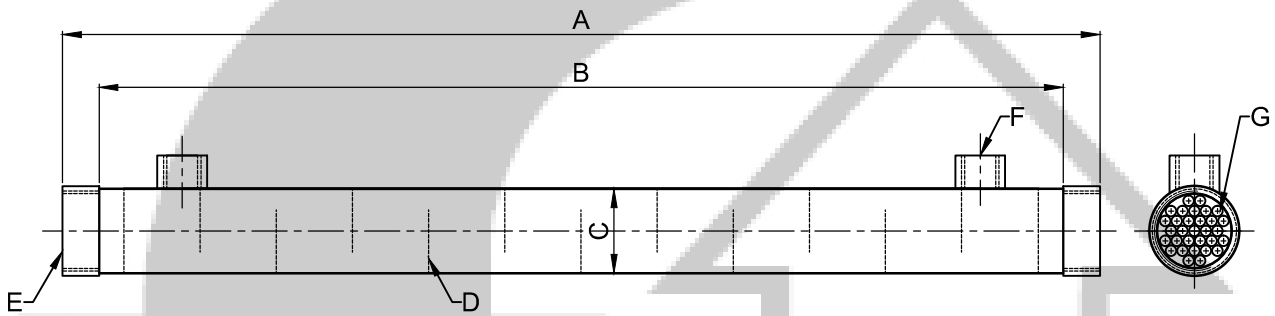

Model	A	B	C	D	E	F	G
5 KW	464	420	Ø50.8	7	1½" BSP	½" BSP	Ø6
10 KW	624	580	Ø50.8	11	1½" BSP	½" BSP	Ø6
15 KW	794	750	Ø50.8	15	1½" BSP	½" BSP	Ø6

RADIATOR-TOYOTA

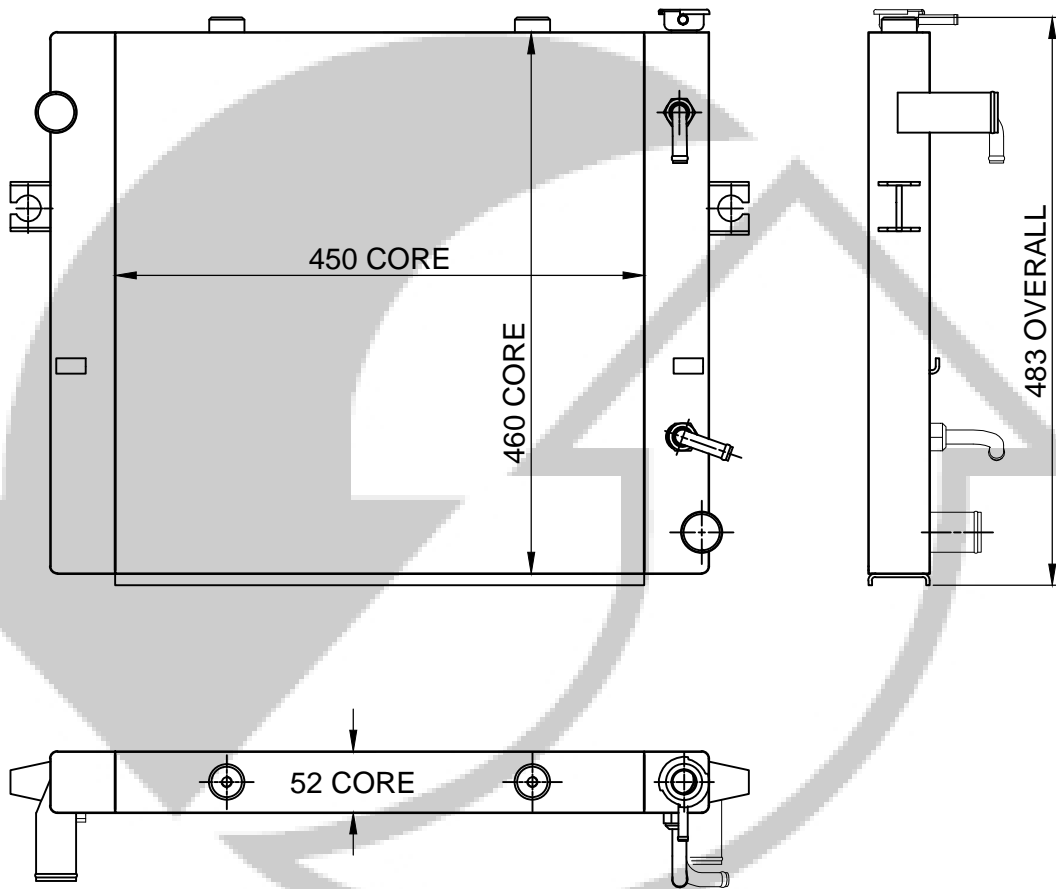

MODEL: TOYOTA FORKLIFT 1.8 TON

PART NUMBER: RAD450TOY1COM

RADIATOR-TOYOTA

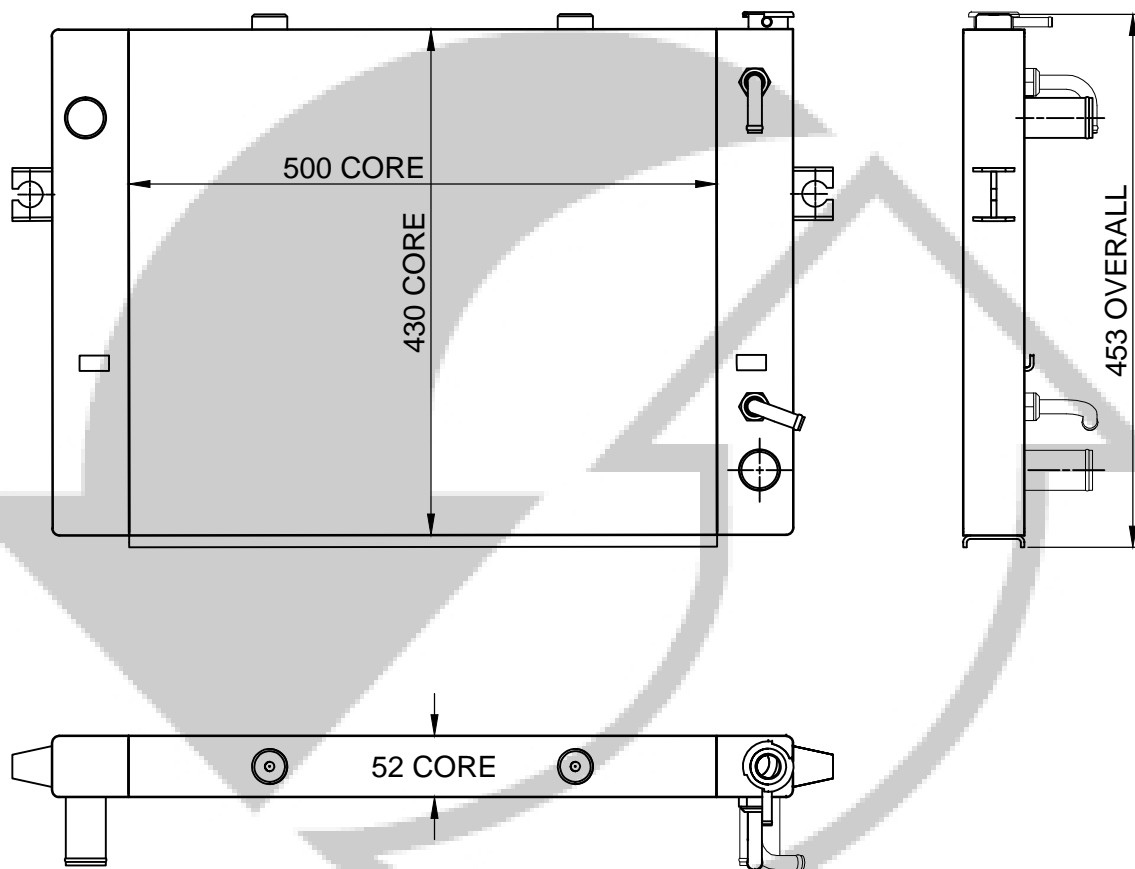

MODEL: TOYOTA FORKLIFT 2.5 TON

PART NUMBER: RAD500TOY1COM

RADIATOR-VOLVO

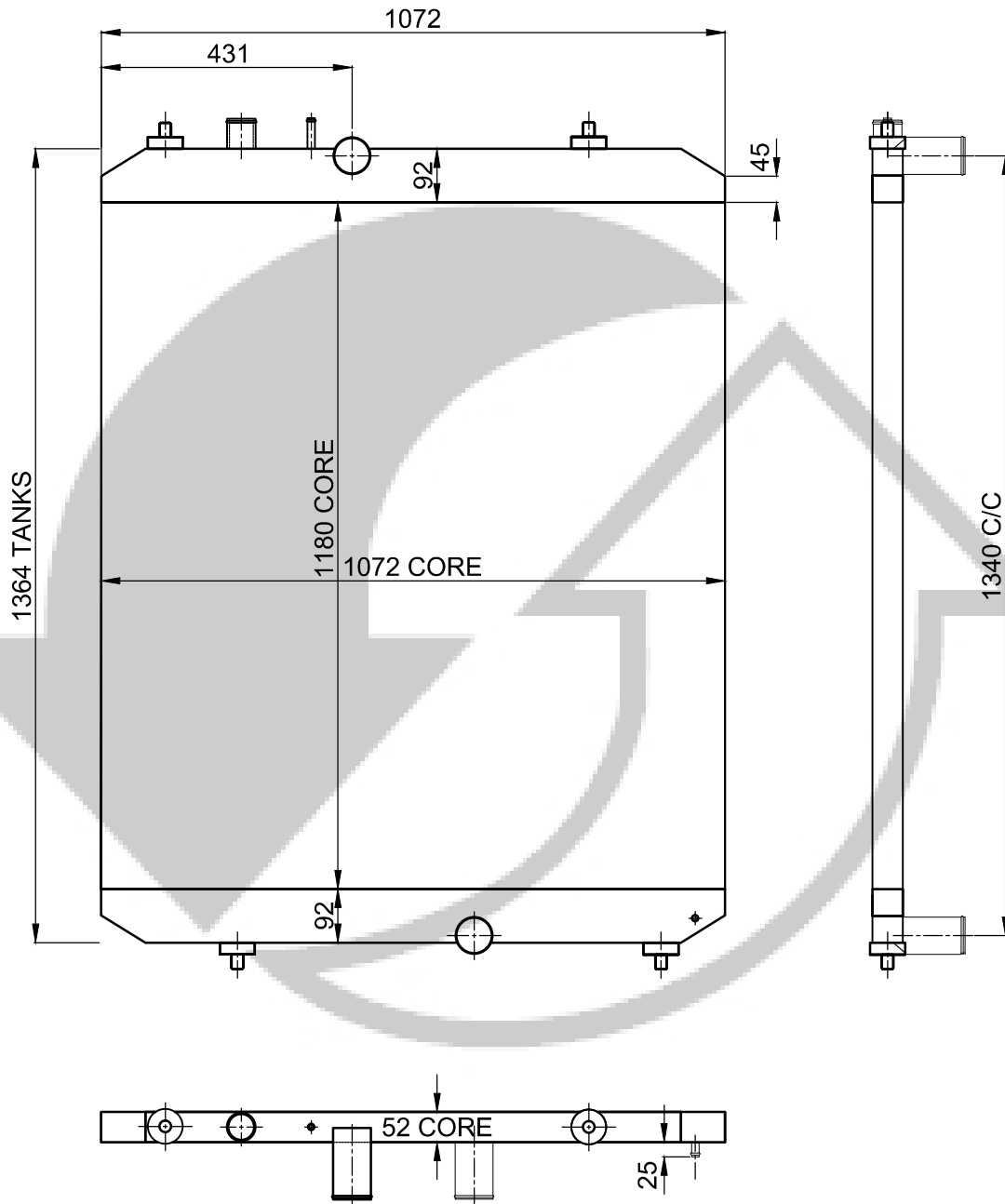

ALSO AVAILABLE IN COPPER



MODEL:VOLVO PENTA TAD1641GE

PART NUMBER:RAD1180VOL1COM

RADIATOR-VOLVO

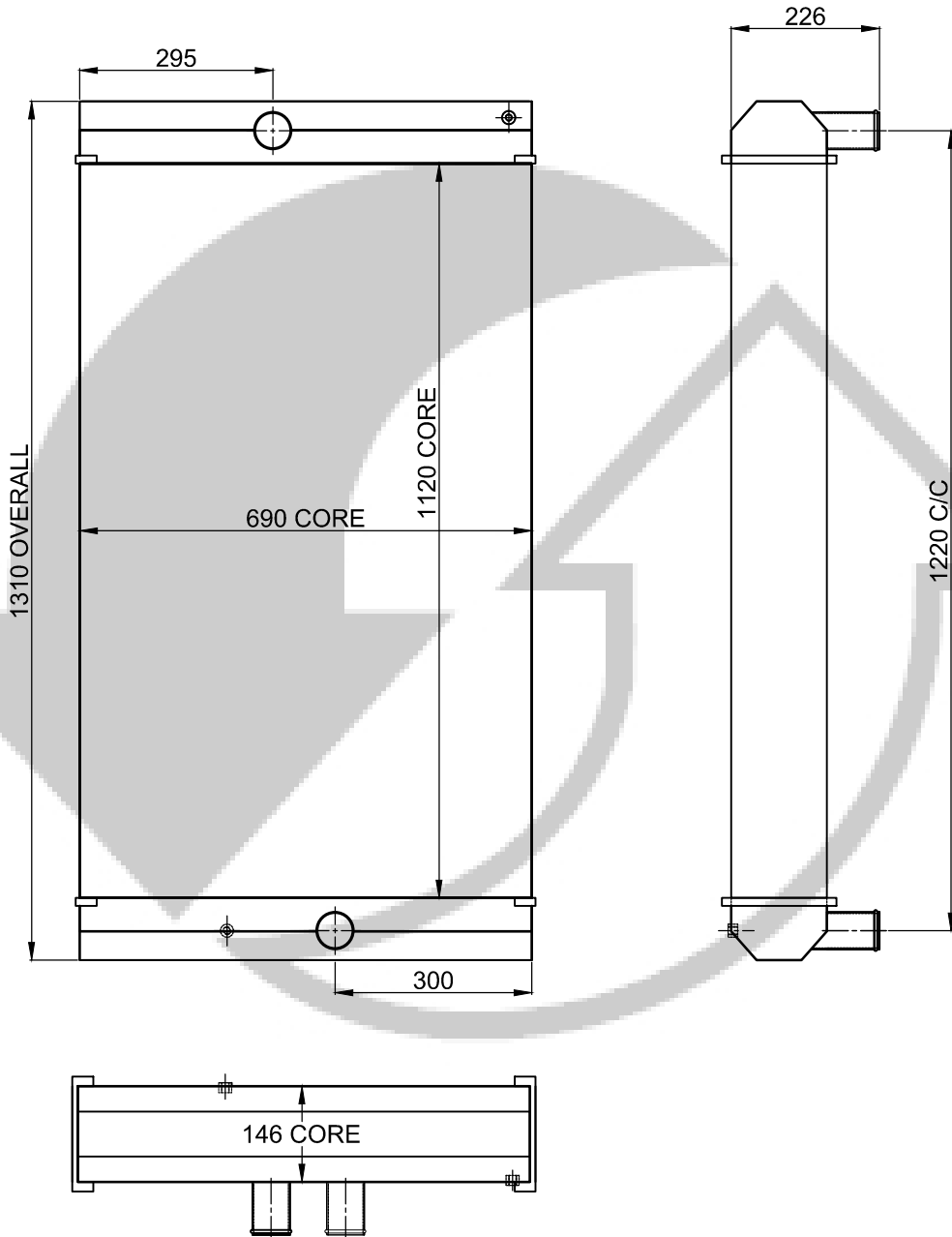

MODEL:VOLVO EC750

PART NUMBER:RAD1120VOL1COM